

GES-4M Stainless Steel Centrifugal Pump 4 pole

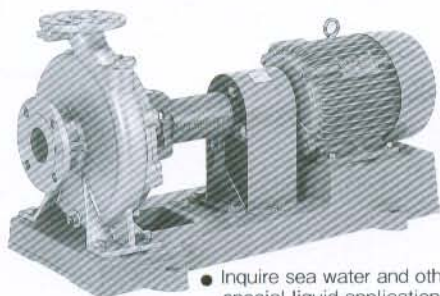

● Inquire sea water and other special liquid applications

Maximum back pressure

$$0.98 \frac{\text{Total head at zero flow (m)} \times 0.098}{10} \text{ MPa} \quad | \quad 10 \frac{\text{Total head at zero flow (m)}}{10} \text{ kgf/cm}^2$$

Maximum suction head (20°C)

— 6m

Selection chart 50Hz

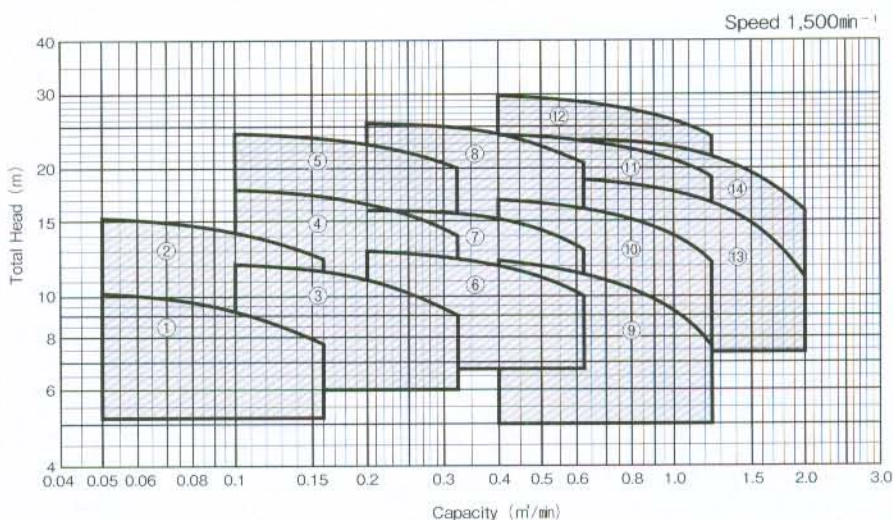

Selection chart 60Hz

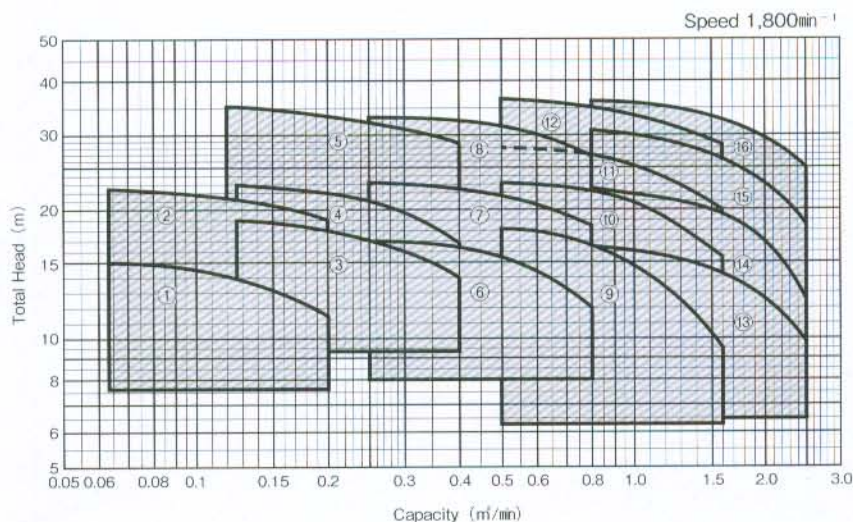

Series products (For special kind liquid applications...Consult to us or our distributors in detail)

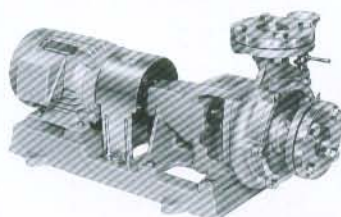

4 pole stainless steel centrifugal pump

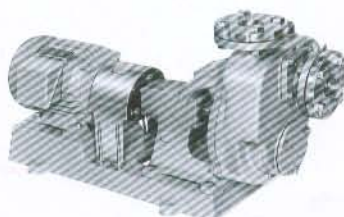

4 pole stainless steel self-priming centrifugal pump

Applications

- Water supply to buildings
- Cold and hot water circulation
- Food, beverage, liquor industry
- Simple city water
- Cooling water
- Special kind liquid
- Other general water supply

Features

- Sanitary and clean due to stainless material are used for portion contacting liquid
- Maintenance is easy because Long life mechanical seal is adopted for shaft sealing
- Easy maintenance and inspection because of back pull out construction
- High efficiency and high total head pump design by using precision cast stainless steel material
- Evaluated item of [horizontal centrifugal pump] by (C) Public Buildings Association., Ltd.

Standard specifications

- Liquid Clean water 0 ~ 90°C
- Materials Impeller SCS14
Shaft SUS316 (portion contacting water), Casing SCS13
- Construction Impeller : Close
Shaft sealing : Mechanical seal (SiC x Carbon)
Bearing : Sealed ball bearing
- Installation Indoor
- Flange JIS 10K

Standard accessories

Motor, base, coupling, coupling cover

STAINLESS STEEL

50Hz

Stainless Steel

60Hz

Accessories

GES-4M

■ Specification & outline dimension table Inquire specification sheets and drawings in case of actual work planning

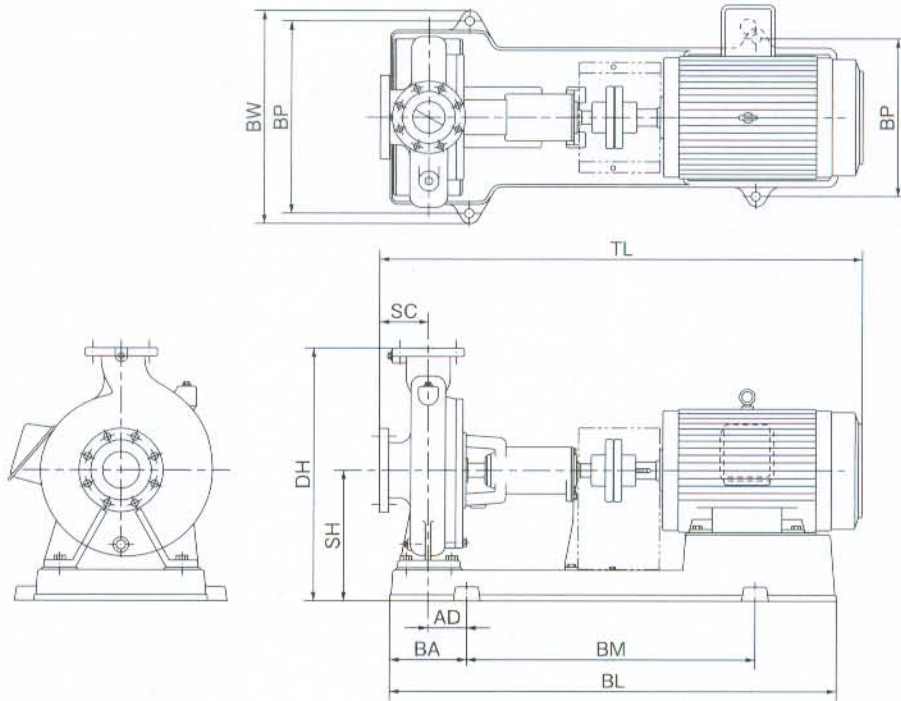

Hz	Suction Bore mm	Discharge Bore mm	Ref No	Model	Motor kW	Performance				Maximum Back pressure MPa [kgf/cm ²]	Dimensions (mm)										Weight kg	
						Capacity m ³ /min	Head m	Capacity m ³ /min	Head m		SC	BL	BA	BM	BP	BW	DH	SH	TL	AD		
50	40	32	1	GES-405M-4M0.4	0.4	0.05	10.2	0.16	7.8	0.98MPa [10kgf/cm ²] - Pump pressure at zero (0) flow	80	654	112	420	336	395	215	681	45	53		
			2	GES-405M-4M0.75	0.75	0.05	15.2	0.16	12.5		80	733	122	480	336	395	215	746	55	65		
	50	40	3	GES-505M-4M0.75	0.75	0.1	12.2	0.32	9		100	733	122	480	366	395	215	766	55	67		
			4	GES-505M-4M1.5	1.5	0.1	18	0.32	14		100	825	138	540	458	470	245	842	55	80		
			5	GES-505M-4M2.2	2.2	0.1	24.2	0.32	20		100	825	138	540	458	470	245	842	55	86		
	65	50	6	GES-655M-4M1.5	1.5	0.2	13	0.63	10		100	731	122	480	366	415	215	778	55	71		
			7	GES-655M-4M2.2	2.2	0.2	16	0.63	13.2		100	731	122	480	366	425	225	819	55	80		
			8	GES-655M-4M3.7	3.7	0.2	25.5	0.63	20.8		100	825	138	540	458	470	245	842	55	100		
			9	GES-805M-4M2.2	2.2	0.4	12.5	1.25	7.5		100	825	138	540	458	470	245	842	55	89		
			80	65	10	GES-805M-4M3.7	3.7	0.4	17		1.25	12.2	100	823	138	540	498	470	245	840	55	93
					11	GES-805M-4M5.5	5.5	0.4	24		1.25	19.2	100	923	158	600	498	515	265	1001	60	130
	100	80	12	GES-805M-4M7.5	7.5	0.4	29.5	1.25	23.5		125	1029	180	660	548	590	310	1054	80	169		
			13	GES-1005M-4M5.5	5.5	0.63	19	2.0	11.2		125	1029	180	660	548	590	310	1054	80	157		
			14	GES-1005M-4M7.5	7.5	0.63	23.5	2.0	16		125	1029	180	660	548	590	310	1064	80	167		
60	40	32	1	GES-406M-4M0.75	0.75	0.063	15	0.2	11.5	0.98MPa [10kgf/cm ²] - Pump pressure at zero (0) flow	80	733	122	480	336	395	215	746	55	64		
			2	GES-406M-4M1.5	1.5	0.063	22.5	0.2	19		80	734	123	480	336	405	225	758	55	66		
	50	40	3	GES-506M-4M1.5	1.5	0.125	19	0.4	14		100	731	122	480	366	395	215	778	55	69		
			4	GES-506M-4M2.2	2.2	0.125	23	0.4	17		100	825	138	540	458	470	245	842	55	85		
			5	GES-506M-4M3.7	3.7	0.12	35.5	0.4	28.5		100	825	138	540	458	470	245	842	55	95		
	65	50	6	GES-656M-4M2.2	2.2	0.25	17.2	0.8	12		100	731	122	480	366	425	225	819	55	79		
			7	GES-656M-4M3.7	3.7	0.25	23.2	0.8	18.5		100	821	138	540	366	425	225	853	70	86		
			8	GES-656M-4M5.5	5.5	0.25	33.5	0.8	26.5		100	825	140	540	458	490	265	891	55	114		
			9	GES-806M-4M3.7	3.7	0.5	18.2	1.6	9.5		100	823	138	540	458	470	245	840	55	93		
	80	65	10	GES-806M-4M5.5	5.5	0.5	23.2	1.6	15.2		100	825	140	540	458	490	265	891	55	110		
			11	GES-806M-4M7.5	7.5	0.5	28	1.6	20		100	1029	179	660	498	535	285	1039	80	147		
			12	GES-806M-4M11	11	0.5	36.5	1.6	28.5		100	1140	199	740	498	535	285	1177	100	222		
			13	GES-1006M-4M5.5	5.5	0.8	16.5	2.5	10		125	825	140	540	458	490	265	916	55	110		
	100	80	14	GES-1006M-4M7.5	7.5	0.8	22.2	2.5	12.5		125	1021	178	660	498	495	245	1064	95	138		
			15	GES-1006M-4M11	11	0.8	30.5	2.5	18.5		125	1146	199	740	488	548	590	310	1195	100	244	
			16	GES-1006M-4M15	15	0.8	36	2.5	25		125	1146	199	740	488	548	590	310	1240	100	256	

Standard End Suction

In Line

Sealless Magnet Coupling
Stainless Steel

Self-Priming

Accessories