

# PSS(2) Stainless Steel In Line Centrifugal Pump

Petit Line<sup>®</sup> below 0.4kW  
Stainless Steel P Line over 0.75kW  
2 pole



### Applications

- Cold and hot water circulation
- Water supply to buildings
- Industry
- Hot water supply
- Setting for machinery equipment
- Other general water supply

### Features

- Precision cast stainless material protect the pump from rust and thus maintenance is easy
- Long life and strong against leakage due to adoption of high quality mechanical seal which can stand antifreeze
- Strong against deterioration of bearing and insulation due to TEFC motor

### Standard specifications

- Liquid Clean water 0 ~ 90°C
- Materials Impeller SCS13  
Shaft SUS304, Casing SCS13
- Construction Impeller : Close  
Shaft sealing : Mechanical seal (SiC x Carbon)  
Bearing : Sealed ball bearing
- Installation Indoor or outdoor
- Motor TEFC outdoor
- Flange Special flange

### Maximum back pressure

Below 0.15kW	$0.5 - \left( \frac{0.098 \times \text{Total head at zero flow}}{10} \right) \text{MPa}$	$\left\{ 5.1 - \frac{\text{Total head at zero flow}}{10} \right\} \text{kgf/cm}^2$
0.25kW~0.4kW	$0.7 - \left( \frac{0.098 \times \text{Total head at zero flow}}{10} \right) \text{MPa}$	$\left\{ 7.1 - \frac{\text{Total head at zero flow}}{10} \right\} \text{kgf/cm}^2$
Over 0.75kW	$1 - \left( \frac{0.098 \times \text{Total head at zero flow}}{10} \right) \text{MPa}$	$\left\{ 10.2 - \frac{\text{Total head at zero flow}}{10} \right\} \text{kgf/cm}^2$

### Maximum suction head (20°C)

Bore	Maximum suction head
20 ~ 65 mm	-6m
80 mm	50Hz: -5.5m 60Hz: -3m

### Standard accessories

Companion flange

### Selection chart 50Hz

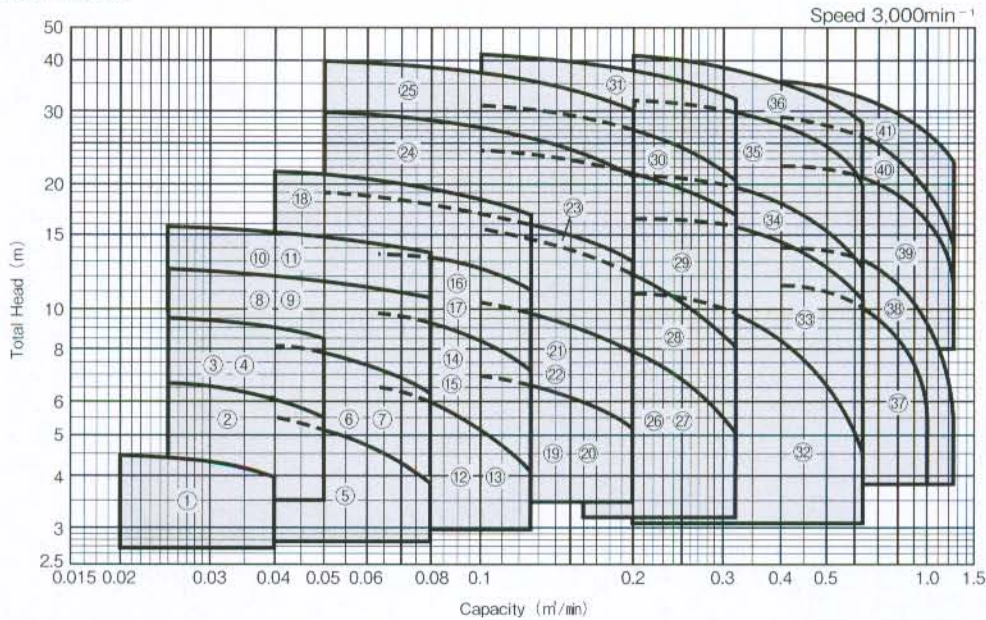

### Selection chart 60Hz

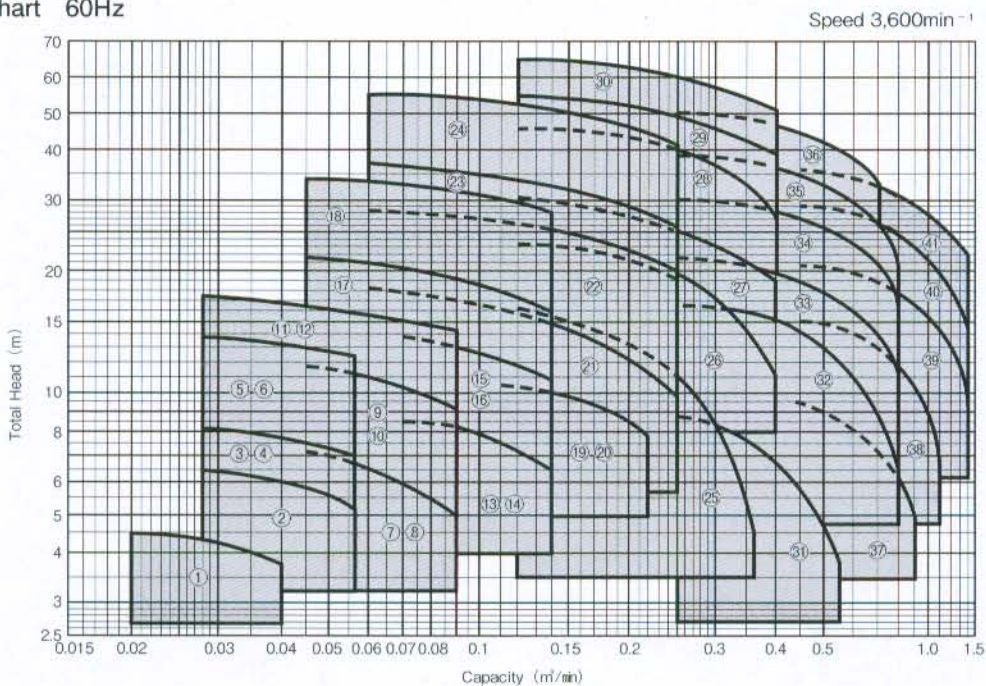

# PSS(2)

## ■ Specification & outline dimension table Inquire specification sheets and drawings in case of actual work planning

Hz	Bore mm	Ref No.	Model	Motor		Performance			
				kW	Capacity m <sup>3</sup> /min	Head m	Capacity m <sup>3</sup> /min	Head m	
20	20	1	PSS2-205-0.06S	0.06	0.02	4.5	0.04	4.0	
		2	PSS2-205-0.1S	0.1	0.025	6.8	0.05	5.5	
		3	PSS2-205-0.15S	0.15	0.025	9.5	0.05	8.5	
		4	PSS2-205-0.15T	0.15	0.025	9.5	0.05	8.5	
25	25	5	PSS2-255-0.1S	0.1	0.04	5.5	0.08	3.8	
		6	PSS2-255-0.15S	0.15	0.04	8.2	0.08	6.2	
		7	PSS2-255-0.15T	0.15	0.04	8.2	0.08	6.2	
		8	PSS2-255-0.25S	0.25	0.025	12.5	0.08	10.5	
		9	PSS2-255-0.25T	0.25	0.025	12.5	0.08	10.5	
		10	PSS2-255-0.4S	0.4	0.025	15.8	0.08	13.8	
		11	PSS2-255-0.4T	0.4	0.025	15.8	0.08	13.8	
32	32	12	PSS2-325-0.15S	0.15	0.063	6.5	0.125	4.2	
		13	PSS2-325-0.15T	0.15	0.063	6.5	0.125	4.2	
		14	PSS2-325-0.25S	0.25	0.063	9.5	0.125	7.2	
		15	PSS2-325-0.25T	0.25	0.063	9.5	0.125	7.2	
		16	PSS2-325-0.4S	0.4	0.063	13.5	0.125	11.2	
		17	PSS2-325-0.4T	0.4	0.063	13.5	0.125	11.2	
		18	PSS-325-0.75	0.75	0.04	21.5	0.125	17.5	
50	40	19	PSS2-405-0.25S	0.25	0.1	7.2	0.2	5.2	
		20	PSS2-405-0.25T	0.25	0.1	7.2	0.2	5.2	
		21	PSS2-405-0.4S	0.4	0.1	10.8	0.2	7.8	
		22	PSS2-405-0.4T	0.4	0.1	10.8	0.2	7.8	
		23	PSS-405-0.75	0.75	0.05	19	0.2	13	
		24	PSS-405-1.5	1.5	0.05	29.5	0.2	21	
		25	PSS-405-2.2	2.2	0.05	40	0.2	30.5	
50	50	26	PSS2-505-0.4S	0.4	0.16	8.8	0.32	5.2	
		27	PSS2-505-0.4T	0.4	0.16	8.8	0.32	5.2	
		28	PSS-505-0.75	0.75	0.1	15.8	0.32	8.5	
		29	PSS-505-1.5	1.5	0.1	24.5	0.32	16.5	
		30	PSS-505-2.2	2.2	0.1	31.5	0.32	20.5	
		31	PSS-505-3.7	3.7	0.1	42.5	0.32	32.5	
65	65	32	PSS-655-0.75	0.75	0.2	10.8	0.63	4.5	
		33	PSS-655-1.5	1.5	0.2	16.2	0.63	10.5	
		34	PSS-655-2.2	2.2	0.2	21	0.63	12.5	
		35	PSS-655-3.7	3.7	0.2	31.8	0.63	20.5	
		36	PSS-655-5.5	5.5	0.2	41	0.63	28	
80	80	37	PSS-805-1.5	1.5	0.4	11.5	1	5.5	
		38	PSS-805-2.2	2.2	0.4	14.2	1.25	5.5	
		39	PSS-805-3.7	3.7	0.4	22.2	1.25	11.5	
		40	PSS-805-5.5	5.5	0.4	29	1.25	14	
		41	PSS-805-7.5	7.5	0.4	35.5	1.25	22.5	

- Antifreezer such as Nybrine Z-1, GD brine 950 and Showbrine PP super of 30 ~ 50% and 0 ~ 90°C can be used for this mechanical seal.
- PSS2-S models are with single phase 100V motor.

Hz	Bore mm	Ref No.	Model	Motor		Performance				
				kW	Capacity m <sup>3</sup> /min	Head m	Capacity m <sup>3</sup> /min	Head m		
20	20	1	PSS2-206-0.06S	0.06	0.02	4.5	0.04	3.8		
		2	PSS2-206-0.1S	0.1	0.028	6.5	0.056	5.2		
		3	PSS2-206-0.15S	0.15	0.028	8.5	0.056	7.0		
		4	PSS2-206-0.15T	0.15	0.028	8.5	0.056	7.0		
		5	PSS2-206-0.25S	0.25	0.028	13.8	0.056	12.5		
		6	PSS2-206-0.25T	0.25	0.028	13.8	0.056	12.5		
25	25	7	PSS2-256-0.15S	0.15	0.045	7.2	0.09	5.0		
		8	PSS2-256-0.15T	0.15	0.045	7.2	0.09	5.0		
		9	PSS2-256-0.25S	0.25	0.045	11.8	0.09	9.2		
		10	PSS2-256-0.25T	0.25	0.045	11.8	0.09	9.2		
		11	PSS2-256-0.4S	0.4	0.028	17.5	0.09	14.5		
		12	PSS2-256-0.4T	0.4	0.028	17.5	0.09	14.5		
32	32	13	PSS2-326-0.25S	0.25	0.071	9.0	0.14	6.5		
		14	PSS2-326-0.25T	0.25	0.071	9.0	0.14	6.5		
		15	PSS2-326-0.4S	0.4	0.071	13.8	0.14	10.8		
		16	PSS2-326-0.4T	0.4	0.071	13.8	0.14	10.8		
		17	PSS-326-0.75	0.75	0.045	21.8	0.14	16.0		
		18	PSS-326-1.5	1.5	0.045	34.0	0.14	28.0		
60	40	19	PSS2-406-0.4S	0.4	0.11	10.5	0.22	7.8		
		20	PSS2-406-0.4T	0.4	0.11	10.5	0.22	7.8		
		21	PSS-406-0.75	0.75	0.06	18.5	0.25	9.5		
		22	PSS-406-1.5	1.5	0.06	28.5	0.25	19.0		
		23	PSS-406-2.2	2.2	0.06	37.8	0.25	26.0		
		24	PSS-406-3.7	3.7	0.06	55.0	0.25	41.0		
50	50	25	PSS-506-0.75	0.75	0.12	17.0	0.36	4.5		
		26	PSS-506-1.5	1.5	0.12	23.8	0.4	11.2		
		27	PSS-506-2.2	2.2	0.12	31.5	0.4	19.0		
		28	PSS-506-3.7	3.7	0.12	45.0	0.4	27.5		
		29	PSS-506-5.5	5.5	0.12	54.0	0.4	39.0		
		30	PSS-506-7.5	7.5	0.12	66.0	0.4	51.0		
65	65	31	PSS-656-0.75	0.75	0.25	8.8	0.56	3.8		
		32	PSS-656-1.5	1.5	0.25	16.5	0.8	6.5		
		33	PSS-656-2.2	2.2	0.25	21.5	0.8	11.5		
		34	PSS-656-3.7	3.7	0.25	30.0	0.8	16.0		
		35	PSS-656-5.5	5.5	0.25	39.5	0.8	20.0		
		36	PSS-656-7.5	7.5	0.25	50.0	0.71	33.0		
80	80	37	PSS-806-1.5	1.5	0.45	9.5	0.9	5.0		
		38	PSS-806-2.2	2.2	0.45	15.0	1.1	6.5		
		39	PSS-806-3.7	3.7	0.45	20.5	1.4	8.8		
		40	PSS-806-5.5	5.5	0.45	29.0	1.4	14.5		
		41	PSS-806-7.5	7.5	0.45	35.0	1.4	22.0		

## ■ Outline dimension drawing Inquire specification sheets and drawings in case of actual work planning

- PE2-S (Single phase)  
PSS2-S (Single phase)

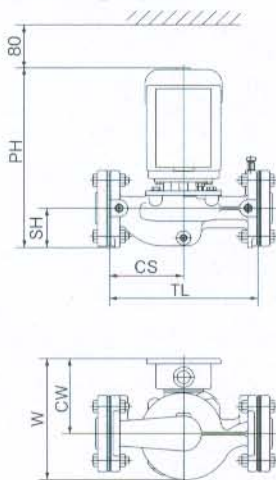

- PE2-T (Three phase)  
PSS2-T (Three phase)

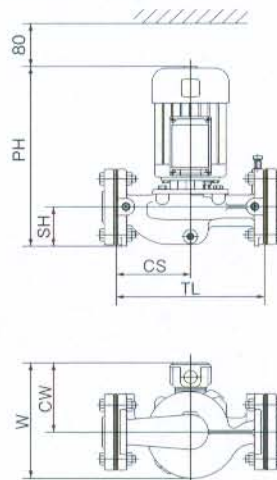

- PE ((Three phase)  
PSS形(Three phase)

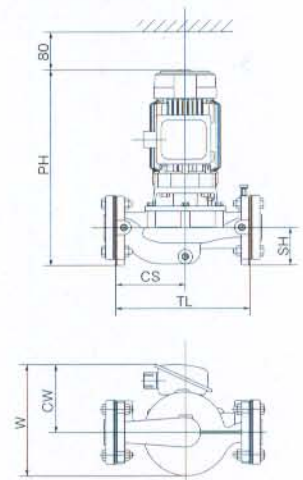

# PE(2)·PSS(2)

## ■ PE(2)

Hz	Bore mm	Motor kW	Dimensions (mm)						Weight kg	Flange figure
			PH	SH	TL	CS	W	CW		
50	20	0.1S	279	46	180	85	198	133	11	Rhombic
		0.15S	279	46	180	85	200	133	11.5	
		0.15T	279	46	180	85	190	123	11	
	25	0.1S	279	46	180	85	198	133	11	Square
		0.15S	278	45	220	110	213	133	12.5	
		0.15T	278	45	220	110	203	123	12	
		0.25S	299	45	220	110	213	133	14	
		0.25T	278	45	220	110	203	123	12.5	
		0.4S	299	45	220	110	213	133	16	
	32	0.15S	298	70	260	130	215	133	17.5	Round
		0.15T	298	70	260	130	205	123	17	
		0.25S	319	70	260	130	215	133	18.5	
0.25T		298	70	260	130	205	123	17		
0.4S		319	70	260	130	215	133	20.5		
0.4T		319	70	260	130	205	123	19.5		
0.75		421	80	280	145	233	143	27		
0.25S		328	75	260	130	215	133	19.5		
0.25T		307	75	260	130	205	123	18		
0.4S		328	75	260	130	215	133	22		
40	0.4T	328	75	260	130	205	123	21	Round	
	0.75	428	87	300	150	235	143	28		
	1.5	456	87	340	175	266	155	37		
	2.2	446	87	340	175	278	167	41		
	0.4S	338	80	290	145	215	133	23.5		
	0.4T	338	80	290	145	205	123	22.5		
	0.75	440	95	315	160	237	143	29		
	1.5	469	95	315	160	249	155	35		
65	2.2	460	95	340	175	287	167	45	Round	
	3.7	500	95	340	175	287	167	52		
	0.75	446	100	340	170	247	143	32		
	1.5	475	100	340	170	259	155	39		
80	2.2	465	100	340	170	273	167	47	Round	
	3.7	505	100	340	175	290	167	56		
	1.5	495	110	370	190	278	155	49		
	2.2	485	110	370	190	290	167	53		
	3.7	530	110	390	200	298	167	63		
	5.5	590	110	390	200	329	194	75		
7.5	610	110	390	200	340	205	98			

## ■ PSS(2)

Hz	Bore mm	Motor kW	Dimensions (mm)						Weight kg	Flange figure
			PH	SH	TL	CS	W	CW		
50	20	0.06S	264	33	150	75	183	133	8	Rhombic
		0.1S	274	40	220	110	213	133	10.5	
		0.15S	274	40	220	110	213	133	11	
	25	0.15T	274	40	220	110	201	123	10.5	Square
		0.1S	274	40	220	110	213	133	10.5	
		0.15S	274	40	220	110	213	133	11	
		0.15T	274	40	220	110	202	123	10.5	
		0.25S	295	40	220	110	213	133	12.5	
		0.25T	274	40	220	110	202	123	11	
	32	0.4S	295	40	220	110	213	133	14	Round
		0.4T	295	40	220	110	202	123	13	
		0.15S	279	45	220	110	217	133	12	
0.15T		279	45	220	110	207	123	11.5		
0.25S		300	45	220	110	217	133	13		
0.25T		279	45	220	110	207	123	11.5		
0.4S		300	45	220	110	217	133	15		
0.4T		300	45	220	110	207	123	14		
0.75		411	70	260	130	234	143	25		
40		0.25S	308	50	220	110	214	133	13.5	
	0.25T	287	50	220	110	204	123	12		
	0.4S	308	50	220	110	214	133	16		
	0.4T	308	50	220	110	204	123	15		
	0.75	416	75	260	130	238	143	25		
	1.5	444	75	280	140	263	155	34		
	2.2	434	75	280	140	275	167	37		
	0.4S	317	55	220	110	218	133	16.5		
0.4T	317	55	220	110	208	123	15.5			
65	0.75	425	80	260	130	238	143	27	Round	
	1.5	454	80	260	130	250	155	34		
	2.2	465	100	340	170	273	167	44		
	3.7	505	100	340	175	290	167	52		
80	0.75	446	100	340	170	247	143	32	Round	
	1.5	475	100	340	170	259	155	38		
	2.2	465	100	340	170	273	167	44		
80	3.7	505	100	340	175	290	167	52	Round	
	1.5	495	110	370	190	278	155	44		
	2.2	485	110	370	190	290	167	48		
3.7	530	110	390	200	298	167	56			

Hz	Bore mm	Motor kW	Dimensions (mm)						Weight kg	Flange figure
			PH	SH	TL	CS	W	CW		
60	20	0.1S	279	46	180	85	198	133	11	Rhombic
		0.15S	279	46	180	85	198	133	11.5	
		0.15T	279	46	180	85	188	123	11	
	25	0.25S	300	46	180	85	200	133	12.5	Square
		0.25T	279	46	180	85	190	123	11	
		0.15S	278	45	220	110	213	133	12.5	
		0.15T	278	45	220	110	203	123	12	
		0.25S	299	45	220	110	213	133	14	
		0.25T	278	45	220	110	203	123	12.5	
	32	0.4S	299	45	220	110	213	133	16	Round
		0.4T	299	45	220	110	203	123	15	
		0.25S	319	70	260	130	215	133	18.5	
0.25T		298	70	260	130	205	123	17		
0.4S		319	70	260	130	215	133	20.5		
0.4T		319	70	260	130	205	123	19.5		
0.75		421	80	260	135	220	143	27		
1.5		450	80	280	145	245	155	33		
0.4S		328	75	260	130	215	133	22		
0.4T		328	75	260	130	205	123	21		
40	0.75	428	87	300	150	235	143	29	Round	
	1.5	457	87	300	150	247	155	34		
	2.2	446	87	340	175	278	167	41		
	0.75	440	95	315	160	237	143	28		
	1.5	469	95	315	160	249	155	35		
	2.2	459	95	315	160	261	167	38		
	3.7	500	95	340	175	287	167	51		
	1.5	475	100	340	170	259	155	39		
65	2.2	465	100	340	170	271	167	42	Round	
	3.7	505	100	340	170	273	167	53		
	2.2	485	110	370	190	290	167	52		
80	3.7	525	110	370	190	290	167	59	Round	
	5.5	590	110	390	200	325	194	74		
	7.5	610	110	390	200	336	205	97		